



Welcome to [E-XFL.COM](https://www.e-xfl.com)

What is "[Embedded - Microcontrollers](#)"?

"[Embedded - Microcontrollers](#)" refer to small, integrated circuits designed to perform specific tasks within larger systems. These microcontrollers are essentially compact computers on a single chip, containing a processor core, memory, and programmable input/output peripherals. They are called "embedded" because they are embedded within electronic devices to control various functions, rather than serving as standalone computers. Microcontrollers are crucial in modern electronics, providing the intelligence and control needed for a wide range of applications.

Applications of "[Embedded - Microcontrollers](#)"

Details

Product Status	Not For New Designs
Core Processor	56800E
Core Size	16-Bit
Speed	60MHz
Connectivity	CANbus, SCI, SPI
Peripherals	POR, PWM, Temp Sensor, WDT
Number of I/O	21
Program Memory Size	32KB (16K x 16)
Program Memory Type	FLASH
EEPROM Size	-
RAM Size	6K x 16
Voltage - Supply (Vcc/Vdd)	2.25V ~ 3.6V
Data Converters	A/D 6x12b
Oscillator Type	Internal
Operating Temperature	-40°C ~ 105°C (TA)
Mounting Type	Surface Mount
Package / Case	48-LQFP
Supplier Device Package	48-LQFP (7x7)
Purchase URL	https://www.e-xfl.com/product-detail/nxp-semiconductors/mc56f8322vfae

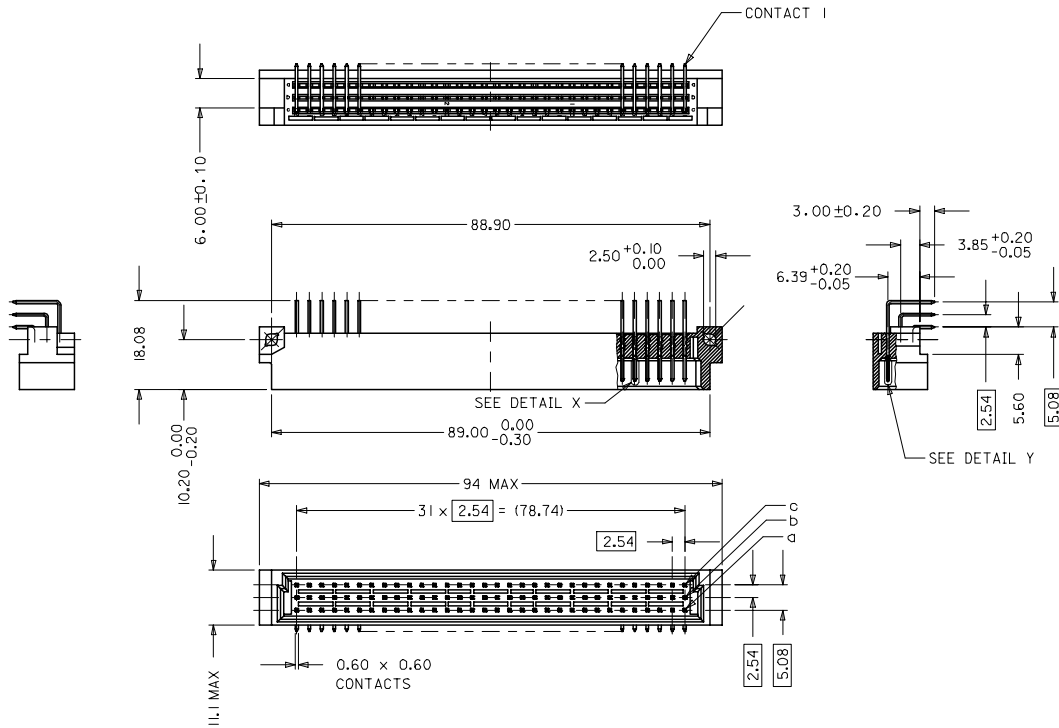

WITH MOUNTING CLIPS

8:

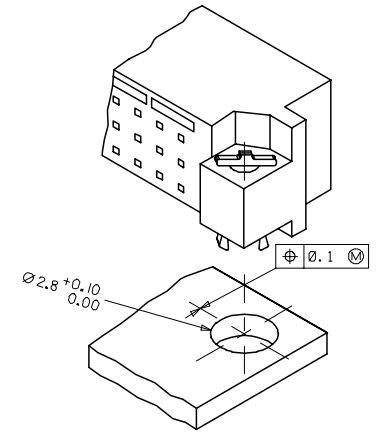
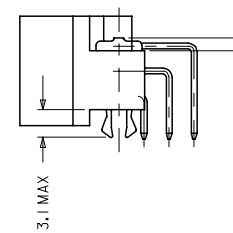

NOTES:

- 1) MATERIALS: PCT, GLASS FILLED, UL94V-0, COLOUR: NATURAL
TERMINAL - BRASS
MOUNTING CLIP: STEEL
- 2) FINISH: TERMINAL:-
CONTACT AREA

1. PERFORMANCE LEVEL 1: SELECTIVE GOLD (Au), THICKNESS = 1.1 MICROMETER
OVER NICKEL, THICKNESS = 1.25 MICROMETER
2. PERFORMANCE LEVEL 2: SELECTIVE GOLD (Au), THICKNESS = 0.6 MICROMETER
OVER NICKEL, THICKNESS = 1.25 MICROMETER
3. PERFORMANCE LEVEL 3: SELECTIVE GOLD (Au), THICKNESS = 0.3 MICROMETER
OVER NICKEL, THICKNESS = 1.25 MICROMETER
TERMINATION AREA:
SELECTIVE TIN, THICKNESS = 2.5 MICROMETER
OVER NICKEL, THICKNESS = 1.25 MICROMETER OVERALL

- 3) MOUNTING CLIP:-
TIN (Sn), THICKNESS = 5-10 MICROMETER,
OVER NICKEL (Ni), THICKNESS = 2.5 MICROMETER
- 4) FOR NON MOUNTING CLIP OPTION, CONNECTOR TO BE SECURED WITH
RIVETS: 2 TUBULAR RIVETS 2.5 x 0.3 ... DIN 7340
SCREWS: 2 CHEESEHEAD SCREWS M2.5 x DIN 84 AND 2 HEXAGONAL NUTS M2.5 DIN 934
REFER SHEET 2.
- 5) FOR CUSTOMER PART NO. PRINTING DETAILS
REFER SHEET 2.
- 6) CUT FACE OF TIP WITHOUT PLATING PERMITTED
- 7) PRODUCT SPECIFICATION PS : 36502-002

RECOMMENDED PCB LAYOUT COMPONENT SIDE

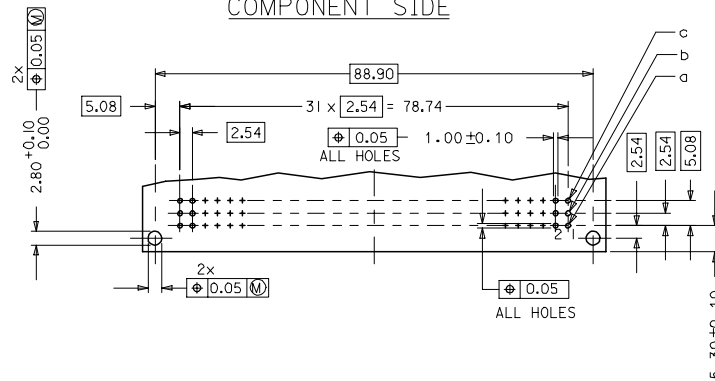

RoHS COMPLIANT

ENTER DESCRIPTION		QUALITY SYMBOLS		GENERAL TOLERANCES (UNLESS SPECIFIED)		DIMENSION STYLE		SCALE		DESIGN UNITS		THIRD ANGLE PROJECTION	
ELECTRIC: 1207-0281		DRAWN BY SHANKAR		DATE 2006/05/30		MM ONLY		2:1		METRIC		THIRD ANGLE PROJECTION	
DRAWING: 1207-0281		CHECKED BY SSUDHIR		DATE 2006/05/30		4 PLACES ± 0.05		DRAWN BY SHANKAR		DATE 2006/05/30		ASSY DIN41612 96 POS	
CHECKED BY SSUDHIR		DATE 2006/05/30		3 PLACES ± 0.1		CHECKED BY SSUDHIR		DATE 2006/05/30		C MALE, HIGH TEMP CONN.		CUSTOMER SPECIAL PRINT	
APPROVED BY SSUDHIR		DATE 2006/05/30		2 PLACES ± 0.15		APPROVED BY SSUDHIR		DATE 2006/05/30		MATERIAL NO.		SD-36502-020	
MATERIAL NO.		DATE 2006/05/30		1 PLACE ± 0.15		DRAFT WHERE APPLICABLE MUST REMAIN WITHIN DIMENSIONS		SEE SHEET 2		DOCUMENT NO.		1 OF 2	
A2		A1		ANGULAR ± 2°		THIS DRAWING CONTAINS INFORMATION THAT IS PROPRIETARY TO MOLEX INCORPORATED AND SHOULD NOT BE USED WITHOUT WRITTEN PERMISSION		MATERIAL NO.		SD-36502-020		1 OF 2	

tb_frame_A1_P_ME_T Rev. E 2006/04/15	19	18	17	16	15	14
---	----	----	----	----	----	----



RoHS COMPLIANT