

Welcome to [E-XFL.COM](#)

### What is "[Embedded - Microcontrollers](#)"?

"[Embedded - Microcontrollers](#)" refer to small, integrated circuits designed to perform specific tasks within larger systems. These microcontrollers are essentially compact computers on a single chip, containing a processor core, memory, and programmable input/output peripherals. They are called "embedded" because they are embedded within electronic devices to control various functions, rather than serving as standalone computers. Microcontrollers are crucial in modern electronics, providing the intelligence and control needed for a wide range of applications.

### Applications of "[Embedded - Microcontrollers](#)"

#### Details

|                            |   |
|----------------------------|---|
| Product Status             | Obsolete  |
| Core Processor             | AVR   |
| Core Size                  | 8-Bit   |
| Speed                      | 16MHz   |
| Connectivity               | SPI, UART/USART   |
| Peripherals                | Brown-out Detect/Reset, POR, PWM, WDT   |
| Number of I/O              | 27  |
| Program Memory Size        | 8KB (8K x 8)  |
| Program Memory Type        | FLASH   |
| EEPROM Size                | 512 x 8   |
| RAM Size                   | 512 x 8   |
| Voltage - Supply (Vcc/Vdd) | 2.7V ~ 5.5V   |
| Data Converters            | A/D 11x10b; D/A 1x10b   |
| Oscillator Type            | Internal  |
| Operating Temperature      | -40°C ~ 105°C (TA)  |
| Mounting Type              | Surface Mount   |
| Package / Case             | 32-SOIC (0.295", 7.50mm Width)  |
| Supplier Device Package    | 32-SOIC   |
| Purchase URL               | <a href="https://www.e-xfl.com/product-detail/atmel/at90pwm3-16sq">https://www.e-xfl.com/product-detail/atmel/at90pwm3-16sq</a> |

- In-System Programmable via SPI Port
- Internal Calibrated RC Oscillator (8 MHz)
- On-chip PLL for fast PWM (32 MHz, 64 MHz) and CPU (16 MHz)
- Operating Voltage: 2.7V - 5.5V
- Extended Operating Temperature:
  - -40°C to +105°C

| Product               | Package        | 12 bit PWM with<br>deadtime | ADC<br>Input | ADC<br>Diff | Analog<br>Compar | Application  |
|-----------------------|----------------|-----------------------------|--------------|-------------|------------------|--|
| AT90PWM2<br>AT90PWM2B | SO24           | 2 x 2                       | 8            | 1           | 2                | One fluorescent ballast                            |
| AT90PWM3<br>AT90PWM3B | SO32,<br>QFN32 | 3 x 2                       | 11           | 2           | 3                | HID ballast, fluorescent ballast,<br>Motor control |

## 1. History

| Product                | Revision  |
|------------------------|---|
| AT90PWM2<br>AT90PWM3   | First revision of parts, only for running production.   |
| AT90PWM2B<br>AT90PWM3B | <p>Second revision of parts, for all new developments.<br/>The major changes are :</p> <ul style="list-style-type: none"> <li>complement the PSCOUT01, PSCOUT11, PSCOUT21 polarity in centered mode - <a href="#">See “PSCn0 &amp; PSCn1 Basic Waveforms in Center Aligned Mode” on page 140.</a></li> <li>Add the PSC software triggering capture - <a href="#">See “PSC 0 Input Capture Register – PICR0H and PICR0L” on page 171.</a></li> <li>Add bits to read the PSC output activity - <a href="#">See “PSC0 Interrupt Flag Register – PIFR0” on page 173.</a></li> <li>Add some clock configurations - <a href="#">See “Device Clocking Options Select AT90PWM2B/3B” on page 31.</a></li> <li>Change Amplifier Synchronization - <a href="#">See “Amplifier” on page 252.</a> and <a href="#">See “” on page 254.</a></li> <li>Correction of the Errata - <a href="#">See “Errata” on page 351.</a></li> </ul> |

This datasheet deals with product characteristics of AT90PW2 and AT90WM3. It will be updated as soon as characterization will be done.

## 2. Disclaimer

Typical values contained in this datasheet are based on simulations and characterization of other AVR microcontrollers manufactured on the same process technology. Min and Max values will be available after the device is characterized.

## 3. Pin Configurations

**Figure 3-1.** SOIC 24-pin Package

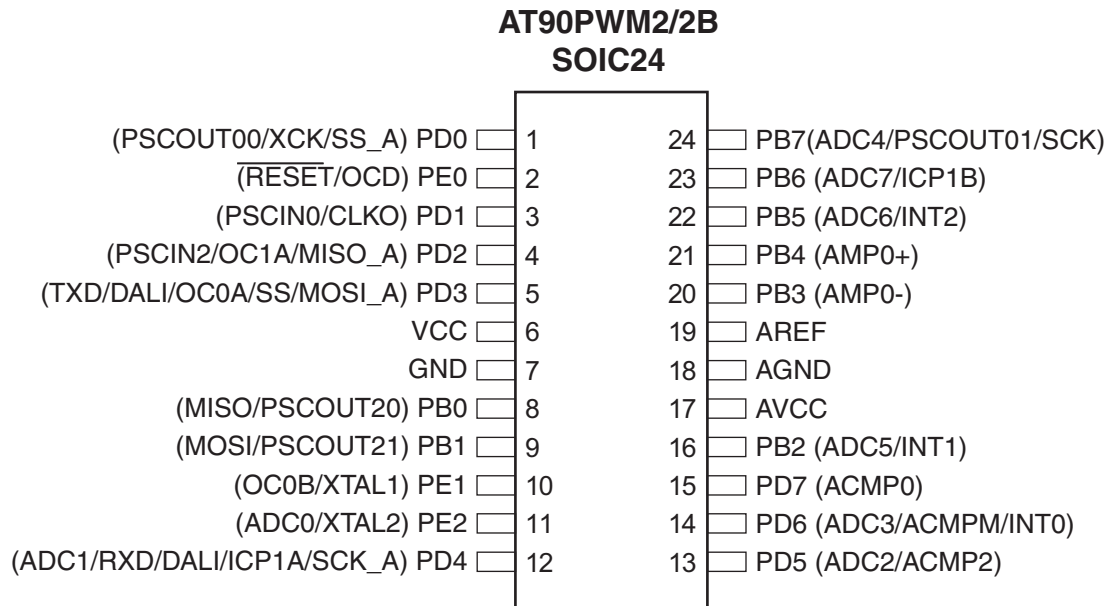

**Figure 3-2.** SOIC 32-pin Package

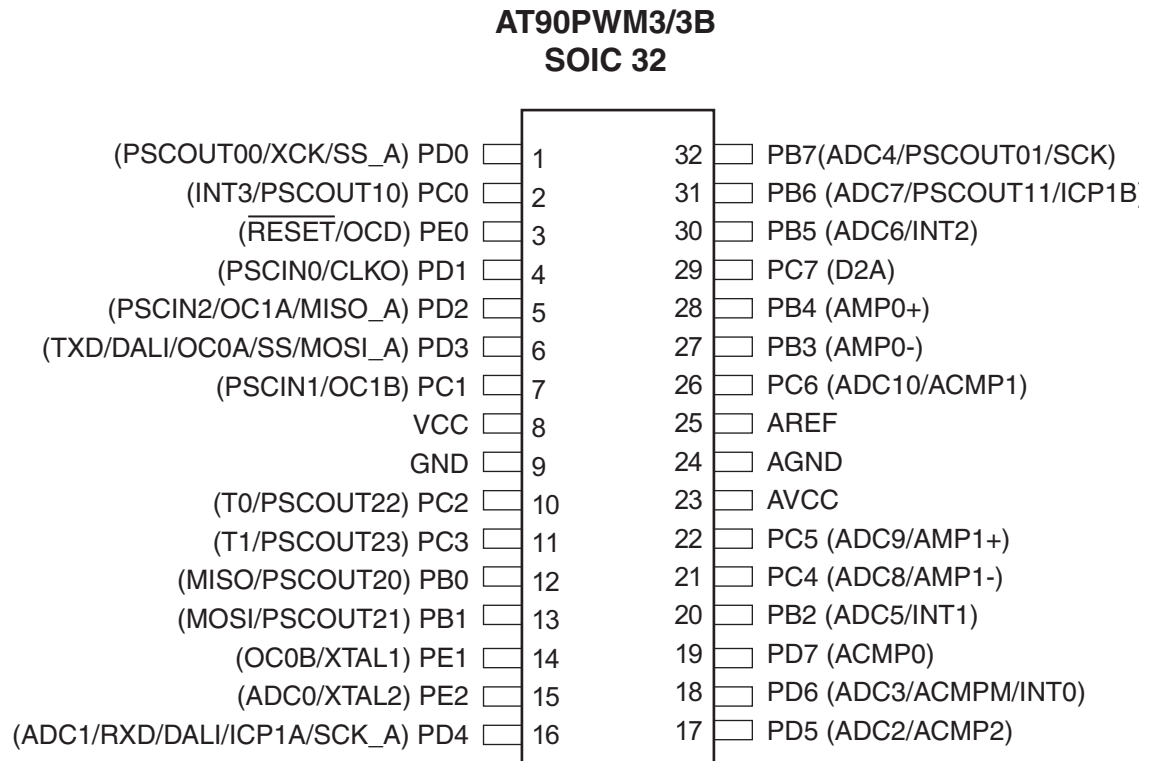

**Figure 3-3.** QFN32 (7\*7 mm) Package.

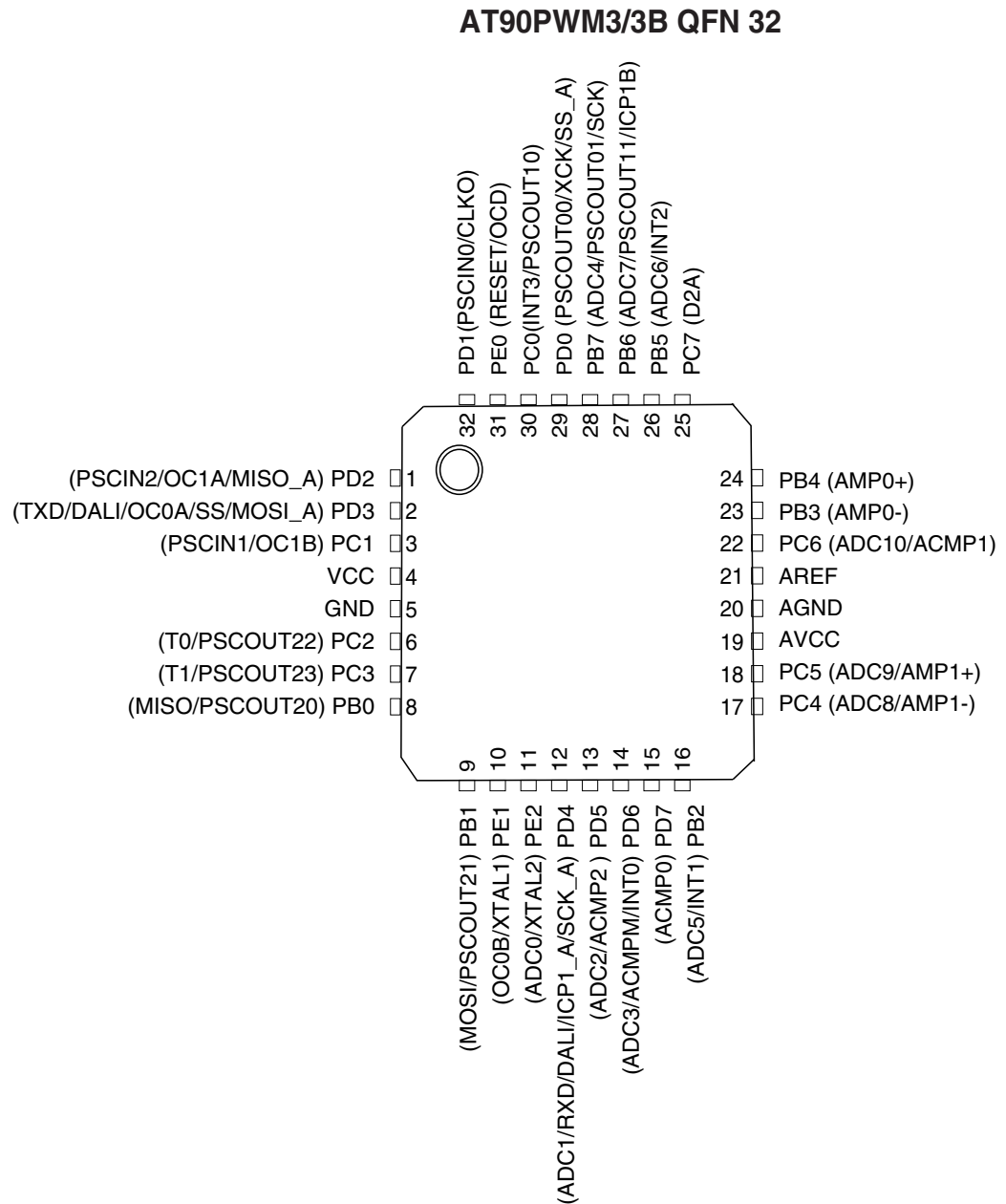

Note: The Center GND PADDLE has to be connected to GND.

## 3.1 Pin Descriptions

Table 3-1. Pin out description

| S024 Pin Number | SO32 Pin Number | QFN32 Pin Number | Mnemonic | Type  | Name, Function & Alternate Function  |
|-----------------|-----------------|------------------|----------|-------|--|
| 7               | 9               | 5                | GND      | Power | <b>Ground:</b> 0V reference  |
| 18              | 24              | 20               | AGND     | Power | <b>Analog Ground:</b> 0V reference for analog part   |
| 6               | 8               | 4                | VCC      | power | <b>Power Supply:</b>   |
| 17              | 23              | 19               | AVCC     | Power | <b>Analog Power Supply:</b> This is the power supply voltage for analog part<br>For a normal use this pin must be connected.                             |
| 19              | 25              | 21               | AREF     | Power | <b>Analog Reference :</b> reference for analog converter . This is the reference voltage of the A/D converter. As output, can be used by external analog |
| 8               | 12              | 8                | PBO      | I/O   | MISO (SPI Master In Slave Out)<br>PSCOUT20 output  |
| 9               | 13              | 9                | PB1      | I/O   | MOSI (SPI Master Out Slave In)<br>PSCOUT21 output  |
| 16              | 20              | 16               | PB2      | I/O   | ADC5 (Analog Input Channel5 )<br>INT1  |
| 20              | 27              | 23               | PB3      | I/O   | AMP0- (Analog Differential Amplifier 0 Input Channel )   |
| 21              | 28              | 24               | PB4      | I/O   | AMP0+ (Analog Differential Amplifier 0 Input Channel )   |
| 22              | 30              | 26               | PB5      | I/O   | ADC6 (Analog Input Channel 6)<br>INT 2   |
| 23              | 31              | 27               | PB6      | I/O   | ADC7 (Analog Input Channel 7)<br>ICP1B (Timer 1 input capture alternate input)<br>PSCOUT11 output (see note 1)   |
| 24              | 32              | 28               | PB7      | I/O   | PSCOUT01 output<br>ADC4 (Analog Input Channel 4)<br>SCK (SPI Clock)  |

**Table 3-1.** Pin out description (Continued)

| S024 Pin Number | S032 Pin Number | QFN32 Pin Number | Mnemonic | Type     | Name, Function & Alternate Function   |
|-----------------|-----------------|------------------|----------|----------|---|
| NA              | 2               | 30               | PC0      | I/O      | PSCOUT10 output (see note 1)<br>INT3  |
|                 | 7               | 3                | PC1      | I/O      | PSCIN1 (PSC 1 Digital Input)<br>OC1B (Timer 1 Output Compare B)   |
|                 | 10              | 6                | PC2      | I/O      | T0 (Timer 0 clock input)<br>PSCOUT22 output   |
|                 | 11              | 7                | PC3      | I/O      | T1 (Timer 1 clock input)<br>PSCOUT23 output   |
|                 | 21              | 17               | PC4      | I/O      | ADC8 (Analog Input Channel 8)<br>AMP1- (Analog Differential Amplifier 1 Input Channel )   |
|                 | 22              | 18               | PC5      | I/O      | ADC9 (Analog Input Channel 9)<br>AMP1+ (Analog Differential Amplifier 1 Input Channel )   |
|                 | 26              | 22               | PC6      | I/O      | ADC10 (Analog Input Channel 10)<br>ACMP1 (Analog Comparator 1 Positive Input )  |
|                 | 29              | 25               | PC7      | I/O      | D2A : DAC output  |
| 1               | 1               | 29               | PD0      | I/O      | PSCOUT00 output<br>XCK (UART Transfer Clock)<br>SS_A (Alternate SPI Slave Select)   |
| 3               | 4               | 32               | PD1      | I/O      | PSCIN0 (PSC 0 Digital Input )<br>CLKO (System Clock Output)   |
| 4               | 5               | 1                | PD2      | I/O      | PSCIN2 (PSC 2 Digital Input)<br>OC1A (Timer 1 Output Compare A)<br>MISO_A (Programming & alternate SPI Master In Slave Out)                     |
| 5               | 6               | 2                | PD3      | I/O      | TXD (Dali/UART Tx data)<br>OC0A (Timer 0 Output Compare A)<br>SS (SPI Slave Select)<br>MOSI_A (Programming & alternate Master Out SPI Slave In) |
| 12              | 16              | 12               | PD4      | I/O      | ADC1 (Analog Input Channel 1)<br>RXD (Dali/UART Rx data)<br>ICP1A (Timer 1 input capture)<br>SCK_A (Programming & alternate SPI Clock)          |
| 13              | 17              | 13               | PD5      | I/O      | ADC2 (Analog Input Channel 2)<br>ACMP2 (Analog Comparator 2 Positive Input )  |
| 14              | 18              | 14               | PD6      | I/O      | ADC3 (Analog Input Channel 3 )<br>ACMPM reference for analog comparators<br>INT0  |
| 15              | 19              | 15               | PD7      | I/O      | ACMP0 (Analog Comparator 0 Positive Input )   |
| 2               | 3               | 31               | PE0      | I/O or I | RESET (Reset Input)<br>OCD (On Chip Debug I/O)  |
| 10              | 14              | 10               | PE1      | I/O      | XTAL1: XTAL Input<br>OC0B (Timer 0 Output Compare B)  |

**Table 3-1.** Pin out description (Continued)

| S024 Pin Number | SO32 Pin Number | QFN32 Pin Number | Mnemonic | Type | Name, Function & Alternate Function                 |
|-----------------|-----------------|------------------|----------|------|---|
| 11              | 15              | 11               | PE2      | I/O  | XTAL2: XTAL OuTput<br>ADC0 (Analog Input Channel 0) |

1. PSCOUT10 & PSCOUT11 are not present on 24 pins package

## 4. Overview

The AT90PWM2/2B/3/3B is a low-power CMOS 8-bit microcontroller based on the AVR enhanced RISC architecture. By executing powerful instructions in a single clock cycle, the AT90PWM2/2B/3/3B achieves throughputs approaching 1 MIPS per MHz allowing the system designer to optimize power consumption versus processing speed.

## 4.1 Block Diagram

**Figure 4-1.** Block Diagram

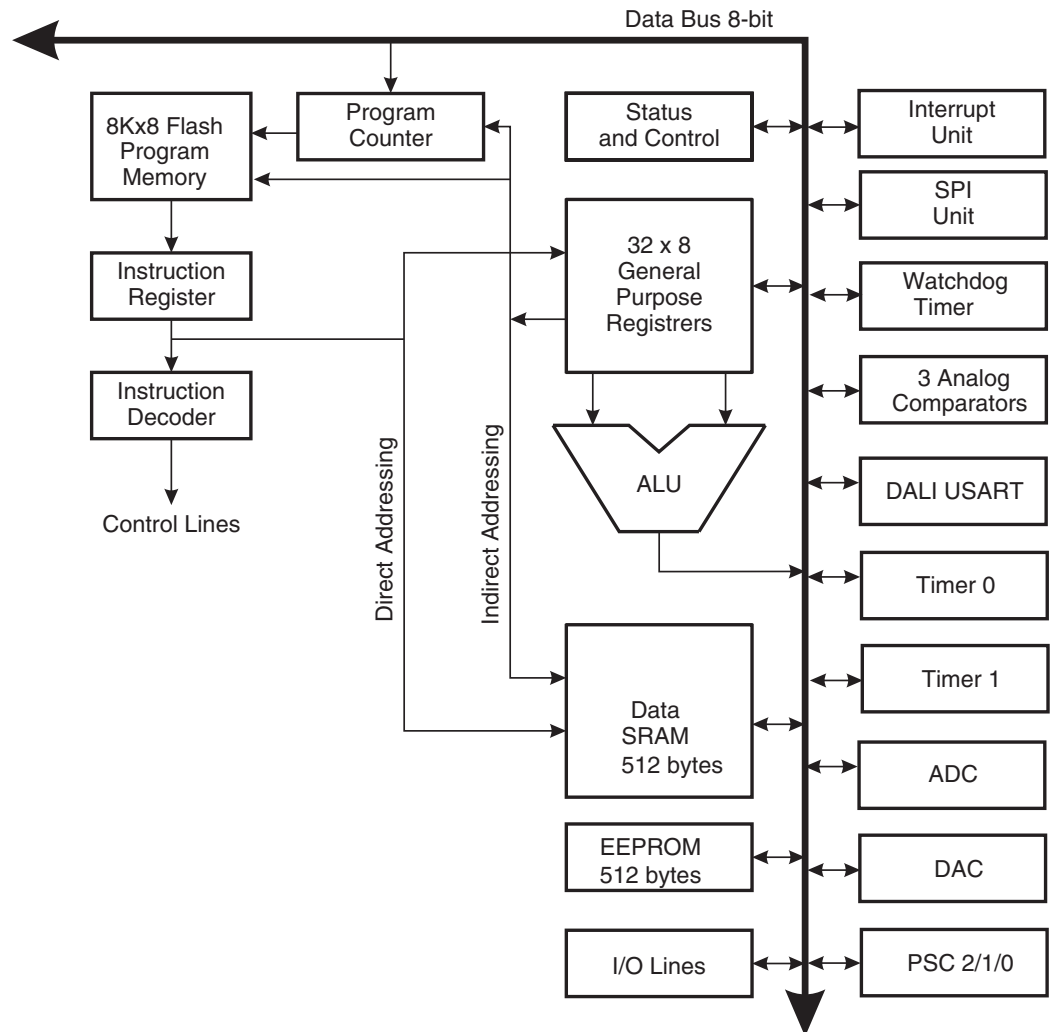

The AVR core combines a rich instruction set with 32 general purpose working registers. All the 32 registers are directly connected to the Arithmetic Logic Unit (ALU), allowing two independent registers to be accessed in one single instruction executed in one clock cycle. The resulting architecture is more code efficient while achieving throughputs up to ten times faster than conventional CISC microcontrollers.

The AT90PWM2/2B/3/3B provides the following features: 8K bytes of In-System Programmable Flash with Read-While-Write capabilities, 512 bytes EEPROM, 512 bytes SRAM, 53 general purpose I/O lines, 32 general purpose working registers, three Power Stage Controllers, two flexible Timer/Counters with compare modes and PWM, one USART with DALI mode, an 11-channel 10-bit ADC with two differential input stage with programmable gain, a 10-bit DAC, a programmable Watchdog Timer with Internal Oscillator, an SPI serial port, an On-chip Debug system and four software selectable power saving modes.



The Idle mode stops the CPU while allowing the SRAM, Timer/Counters, SPI ports and interrupt system to continue functioning. The Power-down mode saves the register contents but freezes the Oscillator, disabling all other chip functions until the next interrupt or Hardware Reset. The ADC Noise Reduction mode stops the CPU and all I/O modules except ADC, to minimize switching noise during ADC conversions. In Standby mode, the Crystal/Resonator Oscillator is running while the rest of the device is sleeping. This allows very fast start-up combined with low power consumption.

The device is manufactured using Atmel's high-density nonvolatile memory technology. The On-chip ISP Flash allows the program memory to be reprogrammed in-system through an SPI serial interface, by a conventional nonvolatile memory programmer, or by an On-chip Boot program running on the AVR core. The boot program can use any interface to download the application program in the application Flash memory. Software in the Boot Flash section will continue to run while the Application Flash section is updated, providing true Read-While-Write operation. By combining an 8-bit RISC CPU with In-System Self-Programmable Flash on a monolithic chip, the Atmel AT90PWM2/3 is a powerful microcontroller that provides a highly flexible and cost effective solution to many embedded control applications.

The AT90PWM2/3 AVR is supported with a full suite of program and system development tools including: C compilers, macro assemblers, program debugger/simulators, in-circuit emulators, and evaluation kits.

## **4.2 Pin Descriptions**

### **4.2.1 VCC**

Digital supply voltage.

### **4.2.2 GND**

Ground.

### **4.2.3 Port B (PB7..PB0)**

Port B is an 8-bit bi-directional I/O port with internal pull-up resistors (selected for each bit). The Port B output buffers have symmetrical drive characteristics with both high sink and source capability. As inputs, Port B pins that are externally pulled low will source current if the pull-up resistors are activated. The Port B pins are tri-stated when a reset condition becomes active, even if the clock is not running.

Port B also serves the functions of various special features of the AT90PWM2/2B/3/3B as listed on [page 69](#).

### **4.2.4 Port C (PC7..PC0)**

Port C is an 8-bit bi-directional I/O port with internal pull-up resistors (selected for each bit). The Port C output buffers have symmetrical drive characteristics with both high sink and source capability. As inputs, Port C pins that are externally pulled low will source current if the pull-up resistors are activated. The Port C pins are tri-stated when a reset condition becomes active, even if the clock is not running.

Port C is not available on 24 pins package.

Port C also serves the functions of special features of the AT90PWM2/2B/3/3B as listed on [page 72](#).

#### **4.2.5 Port D (PD7..PD0)**

Port D is an 8-bit bi-directional I/O port with internal pull-up resistors (selected for each bit). The Port D output buffers have symmetrical drive characteristics with both high sink and source capability. As inputs, Port D pins that are externally pulled low will source current if the pull-up resistors are activated. The Port D pins are tri-stated when a reset condition becomes active, even if the clock is not running.

Port D also serves the functions of various special features of the AT90PWM2/2B/3/3B as listed on [page 75](#).

#### **4.2.6 Port E (PE2..0) $\overline{\text{RESET}}$ /XTAL1/XTAL2**

Port E is an 3-bit bi-directional I/O port with internal pull-up resistors (selected for each bit). The Port E output buffers have symmetrical drive characteristics with both high sink and source capability. As inputs, Port E pins that are externally pulled low will source current if the pull-up resistors are activated. The Port E pins are tri-stated when a reset condition becomes active, even if the clock is not running.

If the RSTDISBL Fuse is programmed, PE0 is used as an I/O pin. Note that the electrical characteristics of PE0 differ from those of the other pins of Port C.

If the RSTDISBL Fuse is unprogrammed, PE0 is used as a Reset input. A low level on this pin for longer than the minimum pulse length will generate a Reset, even if the clock is not running. The minimum pulse length is given in [Table 9-1 on page 47](#). Shorter pulses are not guaranteed to generate a Reset.

Depending on the clock selection fuse settings, PE1 can be used as input to the inverting Oscillator amplifier and input to the internal clock operating circuit.

Depending on the clock selection fuse settings, PE2 can be used as output from the inverting Oscillator amplifier.

The various special features of Port E are elaborated in “[Alternate Functions of Port E](#)” on [page 78](#) and “[Clock Systems and their Distribution](#)” on [page 29](#).

#### **4.2.7 AVCC**

AVCC is the supply voltage pin for the A/D Converter. It should be externally connected to  $V_{CC}$ , even if the ADC is not used. If the ADC is used, it should be connected to  $V_{CC}$  through a low-pass filter.

#### **4.2.8 AREF**

This is the analog reference pin for the A/D Converter.

### **4.3 About Code Examples**

This documentation contains simple code examples that briefly show how to use various parts of the device. These code examples assume that the part specific header file is included before compilation. Be aware that not all C compiler vendors include bit definitions in the header files and interrupt handling in C is compiler dependent. Please confirm with the C compiler documentation for more details.

## 5. Ordering Information

| Speed (MHz) | Power Supply | Ordering Code  | Package | Operation Range           |
|-------------|--------------|----------------|---------|---------------------------|
| 16          | 2.7 - 5.5V   | AT90PWM3-16SQ  | SO32    | Extended (-40°C to 105°C) |
| 16          | 2.7 - 5.5V   | AT90PWM3-16MQT | QFN32   | Extended (-40°C to 105°C) |
| 16          | 2.7 - 5.5V   | AT90PWM3-16MQ  | QFN32   | Extended (-40°C to 105°C) |
| 16          | 2.7 - 5.5V   | AT90PWM2-16SQ  | SO24    | Extended (-40°C to 105°C) |
| 16          | 2.7 - 5.5V   | AT90PWM3B-16SE | SO32    | Engineering Samples       |
| 16          | 2.7 - 5.5V   | AT90PWM3B-16ME | QFN32   | Engineering Samples       |
| 16          | 2.7 - 5.5V   | AT90PWM2B-16SE | SO24    | Engineering Samples       |
| 16          | 2.7 - 5.5V   | AT90PWM3B-16SU | SO32    | Extended (-40°C to 105°C) |
| 16          | 2.7 - 5.5V   | AT90PWM3B-16MU | QFN32   | Extended (-40°C to 105°C) |
| 16          | 2.7 - 5.5V   | AT90PWM2B-16SU | SO24    | Extended (-40°C to 105°C) |

Note: All packages are Pb free, fully LHF

Note: This device can also be supplied in wafer form. Please contact your local Atmel sales office for detailed ordering information and minimum quantities.

Note: Parts numbers are for shipping in sticks (SO) or in trays (QFN). These devices can also be supplied in Tape and Reel. Please contact your local Atmel sales office for detailed ordering information and minimum quantities.

Note: 16MQT = Trays

Note: 16MQ = Tape and Reel

**Note: PWM2 is not recommended for new designs, use PWM2B for your developments**

**Note: PWM3 is not recommended for new designs, use PWM3B for your developments**

## 6. Package Information

| Package Type |                                |
|--------------|--------------------------------|
| <b>SO24</b>  | 24-Lead, Small Outline Package |
| <b>SO32</b>  | 32-Lead, Small Outline Package |
| <b>QFN32</b> | 32-Lead, Quad Flat No lead     |

6.2 SO32

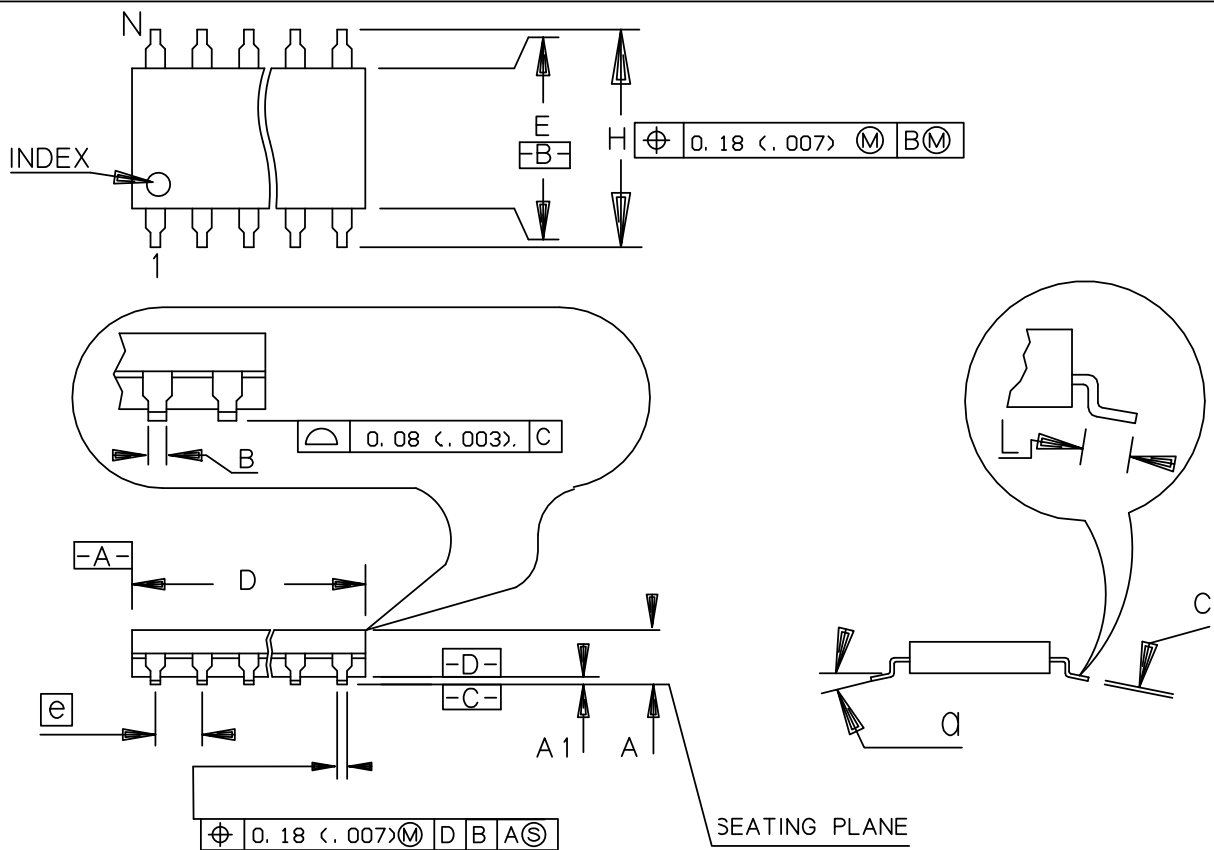

|    | MM    |       | INCH |      |
|----|-------|-------|------|------|
|    | Min   | Max   | Min  | Max  |
| A  | 2.29  | 2.54  | .090 | .100 |
| A1 | 0.10  | 0.25  | .004 | .010 |
| B  | 0.36  | 0.51  | .014 | .020 |
| C  | 0.15  | 0.32  | .006 | .013 |
| D  | 20.57 | 20.88 | .810 | .822 |
| E  | 7.42  | 7.60  | .292 | .299 |
| e  | 1.27  | BSC   | .050 | BSC  |
| H  | 10.29 | 10.64 | .405 | .419 |
| L  | 0.53  | 1.04  | .021 | .041 |
| N  | 32    |       | 32   |      |
| α  | 4°    |       | 4°   |      |

07/27/07



Atmel Nantes S.A.  
La Chantrerie - BP 70602  
44306 Nantes Cedex 3 - France

TITLE  
T4, 32 - Lead, 0.300" Body Width  
Plastic Gull Wing Small Outline Package (SOIC)

DRAWING No.  
T4

REV.  
A

## 6.3 QFN32

### 32 LEADS MicroLEADFRAME

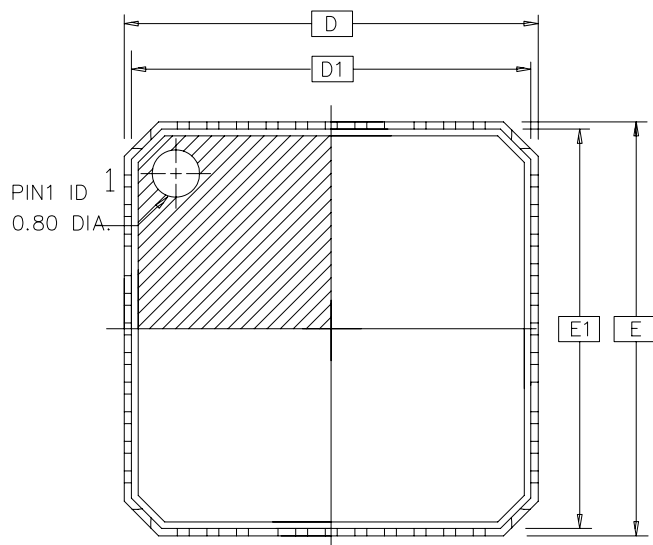

TOP VIEW

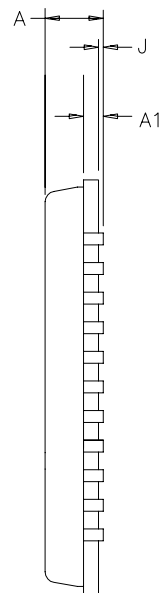

SIDE VIEW

DRAWINGS NOT SCALED

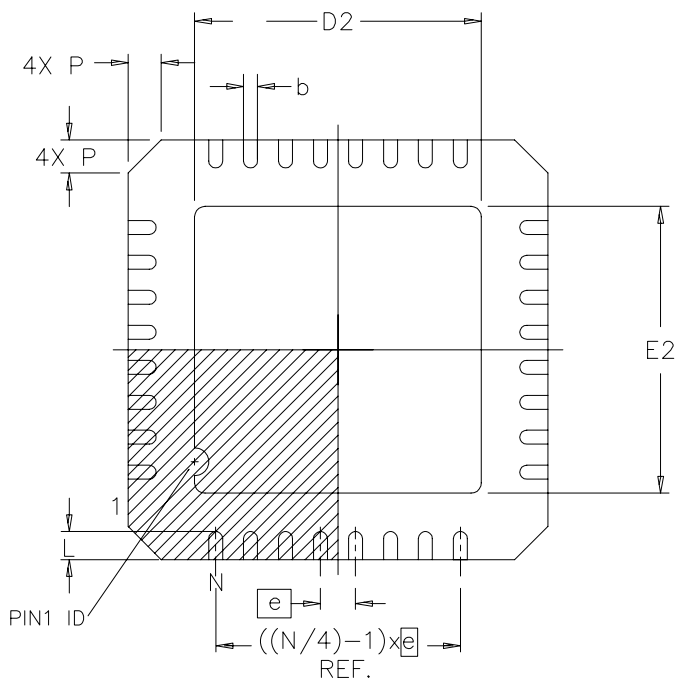

|       | MM       |      |      | INCH     |      |      |
|-------|----------|------|------|----------|------|------|
|       | MIN      | NOM  | MAX  | MIN      | NOM  | MAX  |
| A     | 0.80     | -    | 1.00 | .032     | -    | .040 |
| J     | 0.00     | 0.01 | 0.05 | .000     | .000 | .002 |
| A1    | 0.20 ref |      |      | .008 ref |      |      |
| D/E   | 7.00 BSC |      |      | .276 BSC |      |      |
| D1/E1 | 6.75 BSC |      |      | .266 BSC |      |      |
| D2/E2 | 2.25     | -    | 5.25 | .090     | -    | .207 |
| N     | 32       |      |      |          |      |      |
| P     | 0.24     | 0.42 | 0.60 | .009     | .016 | .024 |
| e     | 0.65 BSC |      |      | .026 BSC |      |      |
| L     | 0.35     | -    | 0.75 | .014     | -    | .030 |
| b     | 0.23     | -    | 0.35 | .009     | -    | .014 |

## NOTES: MLF PACKAGE FAMILY

1. DIE THICKNESS ALLOWABLE IS 0.305mm MAXIMUM(.012 INCHES MAXIMUM)
2. DIMENSIONING & TOLERANCES CONFORM TO ASME Y14.5M. – 1994.
- 3 DIMENSION b APPLIES TO PLATED TERMINAL AND IS MEASURED  
BETWEEN 0.20 AND 0.25mm FROM TERMINAL TIP.
- 4 PACKAGE WARPAGE MAX 0.08mm.
- 5 THE PIN #1 IDENTIFIER MUST BE EXISTED ON THE TOP SURFACE OF THE  
PACKAGE BY USING INDENTATION MARK OR OTHER FEATURE OF PACKAGE BODY.
- 6 EXACT SHAPE AND SIZE OF THIS FIXTURE IS OPTIONAL

## 7. Errata

### 7.1 AT90PWM2&3 Rev. A (Mask Revision)

- **PGM: PSCxRB Fuse**
- **PSC: Prescaler**
- **PSC: PAOCnA and PAOCnB Register Bits (Asynchronous output control)**
- **PSC: PEVxA/B Flag Bits**
- **PSC: Output Polarity in Centered Mode**
- **PSC: Output Activity**
- **VREF**
- **DALI**
- **DAC: Register Update**
- **DAC: Output spikes**
- **DAC driver: Output Voltage linearity**
- **ADC: Conversion accuracy**
- **Analog comparator: Offset value**
- **Analog comparator: Output signal**
- **PSC: Autolock modes**
- **DALI: 17th bit detection**
- **PSC: One ramp mode with PSC input mode 8**

#### 1. **PGM: PSCnRB Fuse**

The use of PSCnRB fuse can make the parallel ISP fail.

Workaround:

When PSCnRB fuses are used, use the serial programming mode to load a new program version.

#### 2. **PSC: Prescaler**

The use of PSC's prescaler have the following effects :

It blocks the sample of PSC inputs until the two first cycles following the set of PSC run bit.

A fault is not properly transferred to other (slave) PSC.

**Workaround:**

Clear the prescaler PPREx bit when stopping the PSC (prun = 0), and set them to appropriate value when starting the PSC (prun = 1), these bits are in the same PCTL register

Do not use the prescaler when a fault on one PSC should affect other PSC's

#### 3. **PSC: PAOCnA and PAOCnB Register Bits (Asynchronous output control)**

These register bits are malfunctioning.

**Workaround:**

Do not use this feature.

#### 4. **PSC: PEVnA/B flag bits**

These flags are set when a fault arises, but can also be set again during the fault itself.

Workaround:

Don't clear these flags before the fault disappears.



## 5. PSC: Output Polarity in Centered Mode

In centered mode, PSCOUTn1 outputs are not inverted, so they are active at the same time as PSCOUTn0.

### Workaround:

Use an external inverter (or a driver with inverting output) to drive the load on PSCOUTn1.

## 6. PSC : POACnA/B Output Activity

These register bits are not implemented in rev A.

### Workaround:

Do not use this feature.

## 7. VREF

**Remark:** To have Internal Vref on AREF pin select an internal analog feature such as DAC or ADC.

Some stand by power consumption may be observed if Vref equals AVcc

## 8. DALI

Some troubles on Dali extension when edges are not symmetric.

### Workaround:

Use an optocoupler providing symmetric edges on Rx and Tx DALI lines (only recommended for software validation purpose).

## 9. DAC: Register Update

Registers DACL & DACH are not written when the DAC is not enabled.

### Workaround:

Enable DAC with DAEN before writing in DACL & DACH. To prevent an unwanted zero output on DAC pin, enable DAC output, with DAOE afterwards.

## 10. DAC : Output spikes

During transition between two codes, a spike may appears

### Work around:

Filter spike or wait for steady state

No spike appears if the 4 last significant bits remain zero.

## 11. DAC driver: Output Voltage linearity

The voltage linearity of the DAC driver is limited when the DAC output goes above Vcc - 1V.

### Work around:

Do not use AVcc as Vref ; internal Vref gives good results

## 12. ADC : Conversion accuracy

The conversion accuracy degrades when the ADC clock is 1 & 2 MHz.

### Work around:

When a 10 bit conversion accuracy is required, use an ADC clock of 500 kHz or below.

## 13. Analog comparator: Offset value

The offset value increases when the common mode voltage is above Vcc - 1.5V.

### Work around:

Limit common mode voltage

## 8. Errata

### 8.1 AT90PWM2&3 Rev. A (Mask Revision)

- **PGM: PSCxRB Fuse**
- **PSC: Prescaler**
- **PSC: PAOCnA and PAOCnB Register Bits (Asynchronous output control)**
- **PSC: PEVxA/B Flag Bits**
- **PSC: Output Polarity in Centered Mode**
- **PSC: Output Activity**
- **VREF**
- **DALI**
- **DAC: Register Update**
- **DAC: Output spikes**
- **DAC driver: Output Voltage linearity**
- **ADC: Conversion accuracy**
- **Analog comparator: Offset value**
- **Analog comparator: Output signal**
- **PSC: Autolock modes**
- **DALI: 17th bit detection**
- **PSC: One ramp mode with PSC input mode 8**

#### 1. **PGM: PSCnRB Fuse**

The use of PSCnRB fuse can make the parallel ISP fail.

**Workaround:**

When PSCnRB fuses are used, use the serial programming mode to load a new program version.

#### 2. **PSC: Prescaler**

The use of PSC's prescaler have the following effects:

It blocks the sample of PSC inputs until the two first cycles following the set of PSC run bit.

A fault is not properly transferred to other (slave) PSC.

**Workaround:**

Clear the prescaler PPREx bit when stopping the PSC (prun = 0), and set them to appropriate value when starting the PSC (prun = 1), these bits are in the same PCTL register

Do not use the prescaler when a fault on one PSC should affect other PSC's

#### 3. **PSC: PAOCnA and PAOCnB Register Bits (Asynchronous output control)**

These register bits are malfunctioning.

**Workaround:**

Do not use this feature.

#### 4. **PSC: PEVnA/B flag bits**

These flags are set when a fault arises, but can also be set again during the fault itself.

**Workaround:**

Don't clear these flags before the fault disappears.

## 5. PSC: Output Polarity in Centered Mode

In centered mode, PSCOUTn1 outputs are not inverted, so they are active at the same time as PSCOUTn0.

### Workaround:

Use an external inverter (or a driver with inverting output) to drive the load on PSCOUTn1.

## 6. PSC: POACnA/B Output Activity

These register bits are not implemented in rev A.

### Workaround:

Do not use this feature.

## 7. VREF

**Remark:** To have Internal Vref on AREF pin select an internal analog feature such as DAC or ADC.

Some stand by power consumption may be observed if Vref equals AVcc

## 8. DALI

Some troubles on Dali extension when edges are not symmetric.

### Workaround:

Use an optocoupler providing symmetric edges on Rx and Tx DALI lines (only recommended for software validation purpose).

## 9. DAC: Register Update

Registers DACL & DACH are not written when the DAC is not enabled.

### Workaround:

Enable DAC with DAEN before writing in DACL & DACH. To prevent an unwanted zero output on DAC pin, enable DAC output, with DAOE afterwards.

## 10. DAC : Output spikes

During transition between two codes, a spike may appears

### Work around:

Filter spike or wait for steady state

No spike appears if the 4 last significant bits remain zero.

## 11. DAC driver: Output Voltage linearity

The voltage linearity of the DAC driver is limited when the DAC output goes above Vcc - 1V.

### Work around:

Do not use AVcc as Vref ; internal Vref gives good results

## 12. ADC : Conversion accuracy

The conversion accuracy degrades when the ADC clock is 1 & 2 MHz.

### Work around:

When a 10 bit conversion accuracy is required, use an ADC clock of 500 kHz or below.

## 13. Analog comparator: Offset value

The offset value increases when the common mode voltage is above Vcc - 1.5V.

### Work around:

Limit common mode voltage

**Work around:**

Use, when  $V_{cc}=5V$ ,  $V_{ref}$  below  $V_{cc}-1V$ .

Or, when  $V_{ref}=V_{cc}=5V$ , do not use codes above 800.

**4. DAC Update in Autotrig mode**

If the CPU writes in DACH register at the same instant that the selected trigger source occurs and DAC Auto Trigger is enabled, the DACH register is not updated by the new value.

**Work around:**

When using the autotrig mode, write twice in the DACH register. The time between the two CPU writes, must be different than the trigger source frequency.



Enabling Unlimited Possibilities®

**Atmel Corporation**

1600 Technology Drive  
San Jose, CA 95110  
USA

**Tel:** (+1) (408) 441-0311

**Fax:** (+1) (408) 487-2600

[www.atmel.com](http://www.atmel.com)

**Atmel Asia Limited**

Unit 01-5 & 16, 19F  
BEA Tower, Millennium City 5  
418 Kwun Tong Roa

Kwun Tong, Kowloon

HONG KONG

**Tel:** (+852) 2245-6100

**Fax:** (+852) 2722-1369

**Atmel Munich GmbH**

Business Campus

Parking 4

D-85748 Garching b. Munich

GERMANY

**Tel:** (+49) 89-31970-0

**Fax:** (+49) 89-3194621

**Atmel Japan G.K.**

16F Shin-Osaki Kangyo Bldg

1-6-4 Osaki, Shinagawa-ku

Tokyo 141-0032

JAPAN

**Tel:** (+81) (3) 6417-0300

**Fax:** (+81) (3) 6417-0370

© 2013 Atmel Corporation. All rights reserved. / Rev.: 4317KS-AVR-03/2013

Atmel®, Atmel logo and combinations thereof, Enabling Unlimited Possibilities®, and others are registered trademarks or trademarks of Atmel Corporation or its subsidiaries. Other terms and product names may be trademarks of others.

Disclaimer: The information in this document is provided in connection with Atmel products. No license, express or implied, by estoppel or otherwise, to any intellectual property right is granted by this document or in connection with the sale of Atmel products. EXCEPT AS SET FORTH IN THE ATMEL TERMS AND CONDITIONS OF SALES LOCATED ON THE ATMEL WEBSITE, ATMEL ASSUMES NO LIABILITY WHATSOEVER AND DISCLAIMS ANY EXPRESS, IMPLIED OR STATUTORY WARRANTY RELATING TO ITS PRODUCTS INCLUDING, BUT NOT LIMITED TO, THE IMPLIED WARRANTY OF MERCHANTABILITY, FITNESS FOR A PARTICULAR PURPOSE, OR NON-INFRINGEMENT. IN NO EVENT SHALL ATMEL BE LIABLE FOR ANY DIRECT, INDIRECT, CONSEQUENTIAL, PUNITIVE, SPECIAL OR INCIDENTAL DAMAGES (INCLUDING, WITHOUT LIMITATION, DAMAGES FOR LOSS AND PROFITS, BUSINESS INTERRUPTION, OR LOSS OF INFORMATION) ARISING OUT OF THE USE OR INABILITY TO USE THIS DOCUMENT, EVEN IF ATMEL HAS BEEN ADVISED OF THE POSSIBILITY OF SUCH DAMAGES. Atmel makes no representations or warranties with respect to the accuracy or completeness of the contents of this document and reserves the right to make changes to specifications and products descriptions at any time without notice. Atmel does not make any commitment to update the information contained herein. Unless specifically provided otherwise, Atmel products are not suitable for, and shall not be used in, automotive applications. Atmel products are not intended, authorized, or warranted for use as components in applications intended to support or sustain life.